

调速电动机 Speed Control Motors

15W

□70mm



规格Specs 连续额定Cont. Rated

型号Model · 类型Type 导线型Lead Wire Type		最大输出功率 Output Power W	电压 Voltage V	频率 Frequency Hz	调速范围 Speed Control Range r/min	容许转矩 Allowance Torque		启动转矩 Starting Torque mN.m	电流 Current A	电容器容量 Capacitor μ F
齿轮轴型 Pinion Shaft	圆轴型 Round Shaft					1200r/min mN.m	90r/min mN.m			
3IK15RGN-AJ	3IK15RA-AJ	15	1ph100	50	90~1400	120	35	55	0.42	6.0
				60	90~1700					
3IK15RGN-EJ	3IK15RA-EJ	15	1ph110	60	90~1700	125	35	55	0.42	5.0
			1ph120							
3IK15RGN-CE	3IK15RA-CE	15	1ph220	50	90~1400	120	35	54	0.26	1.2
			1ph230							
3IK15RGN-HE	3IK15RA-HE	15	1ph220	60	90~1700	85	35	52	0.26	
			1ph230			105		55		

- 电动机铭牌上的型号并无表示电容器种类的(J、E)记号。

With the name on record on the motor nameplate, there is no capacitor types(J、E) marked.

- 各种安全规格以电动机铭牌上的型号取得认证。

When the motor is approved under various safety standards, the model name on the nameplate is the approved model name.

种类/Type

电动机/Motor

机型 Type	型号Model	
	齿轮轴型 Pinion Shaft	圆轴型 Round Shaft
导线型 Lead Wire Type	3IK15RGN-AJ	3IK15RA-AJ
	3IK15RGN-EJ	3IK15RA-EJ
	3IK15RGN-CE	3IK15RA-CE
	3IK15RGN-HE	3IK15RA-HE

平行轴减速器(另售)/

Parallel Shaft Gearhead (Sold Separately)

减速器种类 Gearhead Type	减速器型号 Gearhead Model	减速比Gear Ratio
长寿命·低噪音 Long Life · Low Noise	3GN□K	3、3.6、5、6、7.5、9、 12.5、15、18、25、30、 36、50、60、75、90、 100、120、150、180、200
	3GN10XK (中间减速器Decimal gearhead)	

- 减速器型号的□中为减速比的数值

Enter the gear ratio in the box (□) within the model name

② 装有减速器时的容许转矩

- 减速器·中间减速器另售。
- 减速器型号的□中为减速比的数值。
- 色表示与电动机同一方向运转，其他则为相反方向。
- 转速是以电动机的同步转速（50Hz:1500r/min、60Hz:1800r/min）为基准除以减速比而算出来的数值。实际转速将随负载大小变化而比所示数值减少2%~20%左右。
- 希望以大于下表的减速比进行进一步减速时，可在电动机与减速器之间安装减速比为10的中间减速器。这时的容许转矩为5N·m。

Allowable Torque When Being With Reducer

- Gearheads and decimal gearheads are sold separately.
- Enter the gear ratio in the box(□) within the model name.
- 色 Indicates the same rotating direction of the motor while the others rotate in the opposite direction.
- The speed is calculated by dividing the motor's synchronous speed(50Hz: 1500r/min、60Hz: 1800r/min) by the gear ratio. The actual speed is 2%~20% less than the displayed value, depending on the size of the load.
- To reduce the speed beyond the gear ratio in the table, attach a decimal gearhead(gear ratio:10)between the gearhead and motor. In that case, the permissible torque is 5N·m.

容许力矩单位 Allowance Torque Unit: 上段 Upside (N.m) /下段 Belowside (kgf.cm)

型号Type 电动机 Motor 减速器Gearhead	减速比Gear Ratio	容许力矩单位 Allowance Torque Unit: 上段 Upside (N.m) /下段 Belowside (kgf.cm)																					
		3	3.6	5	6	7.5	9	12.5	15	18	25	30	36	50	60	75	90	100	120	150	180	200	
3IK15RGN-AJ 3IK15RGN-EJ 3IK15RGN-CE 3IK15RGN-HE	3GN□K	50Hz	0.30	0.36	0.51	0.61	0.76	0.91	13	15	18	23	2.7	3.3	41	5	5	5	5	5	5	5	5
		60Hz	3.06	3.67	5.20	6.22	7.75	9.28	13.2	15.3	18.3	23.4	27.5	33.7	41.8	50	50	50	50	50	50	50	50
3IK15RGN-AJ 3IK15RGN-EJ 3IK15RGN-CE 3IK15RGN-HE	3GN□K	50Hz	0.26	0.31	0.43	0.51	0.64	0.77	1.1	1.3	1.5	1.9	2.3	2.8	3.5	4.2	5	5	5	5	5	5	5
		60Hz	2.65	3.16	4.38	5.20	6.53	7.85	11.2	13.2	15.3	19.3	23.4	28.5	35.7	42.8	50	50	50	50	50	50	50

② 容许悬挂负载·容许轴向负载 Permissible Overhung Load and Thrust load

电动机(圆轴型)→201页 Motor(Round shaft type)→P201

减速器→201页 Gearhead→P201

② 减速器的容许负载惯性惯量J Permissible Load Inertia J of Gearhead

→201页 → P201

② 外形图(单位:mm)Dimensions(Unit:mm)

减速器附有安装用螺丝Mounting screws are included with gearhead.

◇导线型 Lead Wire Type

重量Weight:电动机Motor:1.2kg 减速器Gearhead :0.50kg

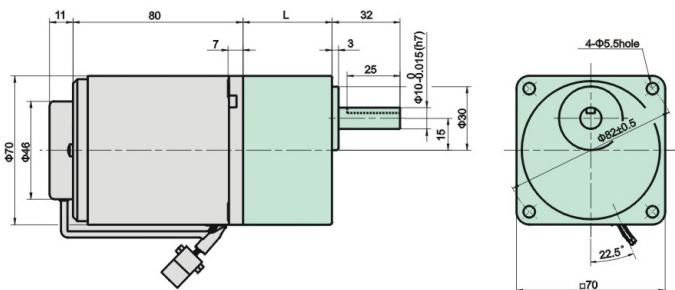

电动机型号 Motor Model	减速器型号 Gearhead Model	减速比 Gear Ratio	L1
3IK15RGN-AJ 3IK15RGN-EJ 3IK15RGN-CE 3IK15RGN-HE	3GN□K	3~18	32
		25~200	42

- 减速器型号的□中为减速比的数值
Enter the gear ratio in the box (□) within the model name

◇ 键 · 键槽(减速器附件)Key · Key Slot
(The key is included with the gearhead)

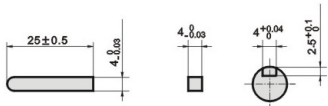

◇ 圆轴型的转轴部分 Shaft Section of Round Shaft Type

除重量及轴部外,电动机外形与齿轮轴型相同。
Excluding weight and the shaft section
Motor shape are the same as those of the pinion shaft

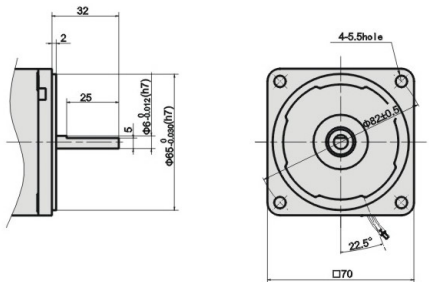

◇ 中间减速器 Decimal Gearhead

可安装在GN齿轮轴型上。
Can be connected to GN pinion shaft type
3GN10XK
重量weight: 0.31kg

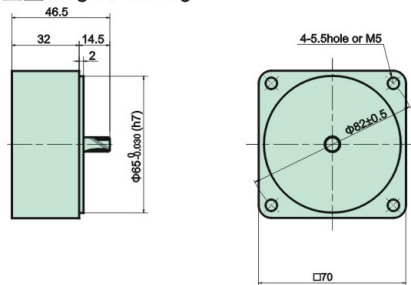

◇ 连接图 Connection Diagrams

