

感应电动机 INDUCTION MOTOR

120W

□104mm



规格 / 连续额定 SPECS / CONTINUOUS RATING

型号 Model 类型 Type	输出功率 Output power W	电压 Voltage V	频率 Frequency Hz	电流 Current A	启动转矩 Starting Torque mN.m	额定转矩 Rated Torque mN.m	额定转速 Rated Speed r/min	电容器容量 Capacitor μ F
6IK120GU-AF (6IK120A-AF)	120	1ph100	50	2.1	600	930	1250	30.0
6IK120GU-EF (6IK120A-EF)			60	2.5			1550	
6IK120GU-CF (6IK120A-CF)	120	1ph110 1ph120	50	1.70	600	750	1550	20.0
6IK120GU-HF (6IK120A-HF)			60	1.80			1550	
6IK120GU-SF (6IK120A-SF)	120	1ph220 1ph230	50	0.95	750	930	1250	8.0
6IK120GU-EFT (6IK120A-EFT)			60	1.0			700	
6IK120GU-CFT (6IK120A-CFT)	120	1ph220 1ph230	50	0.75	2200	890	1300	-
6IK120GU-HFT (6IK120A-HFT)			60	0.70			2000	

● 各种安全规格以电动机铭牌上的型号取得认定。

● When the motor is approved under various safety standards, the model name on the nameplate is the approved model name.

种类 TYPE

● 电动机 MOTOR

机型 Type	型号 Model	
	齿轮轴型 Pinion Shaft	圆轴型 Round Shaft
导线型 Lead Wire Type	6IK120GU-AF	6IK120A-AF
	6IK120GU-EF	6IK120A-EF
	6IK120GU-CF	6IK120A-CF
	6IK120GU-HF	6IK120A-HF
	6IK120GU-SF	6IK120A-SF
带端子箱型 Terminal Box Type	6IK120GU-AFT	6IK120A-AFT
	6IK120GU-EFT	6IK120A-EFT
	6IK120GU-CFT	6IK120A-CFT
	6IK120GU-HFT	6IK120A-HFT
	6IK120GU-SFT	6IK120A-SFT

● 平行轴减速器(另售) PARALLEL SHAFT GEARHEAD (SOLD SEPARATELY)

减速器种类 Gearhead Type	减速器型号 Gearhead Model	减速比 Gear Ratio
长寿命·低噪音 Long Life · Low Noise	6GU□K	3、3.6、5、6、7.5、9、12.5、15、18、25、30、36、50、60、75、90、100、120、150、180、200

● 减速器型号的□中为减速比的数值

● Enter the gear ratio in the box (□) within the model name

■ 装有减速器时的容许转矩 ALLOWABLE TORQUE WHEN BEING WITH GEARHEAD

- 减速器·中间减速器另售
- 电动机型号的□中为表示带端子箱型的记号 (T)
- 减速器型号的□中为减速比的数值。
- □色表示与电动机同一方向运转，其他则为相反方向。
- 转速是以电动机的同步转速 (50Hz: 1500r/min、60Hz: 1800r/min) 为基准除以减速比而算出来的数值。实际转速将随负载大小变化而比所示数值减少 2%~20%左右。
- Gearhead and mid-gearbox can be sold separately.
- Enter the code that represents the terminal box type (T) in the box (□) within the model name.
- Enter the gear ratio in the box (□) within the model name.
- The colored background □ indicates the same rotating direction of the motor while the rotating direction of others are opposite.
- The speed is calculated by dividing the motor's synchronous speed (50Hz: 1500r/min、60Hz: 1800r/min) by the gear ratio. The actual speed is 2%~20% less than the displayed value, depending on the size of the load.

容许力矩单位 Allowance Torque Unit: 上段 Upside (N.m) / 下段 Belowside (kgf.cm)

机型Type 电动机/减速器 Motor/Gearhead	减速比Gear Ratio	3	3.6	5	6	7.5	9	12.5	15	18	25	30	36	50	60	75	90	100	120	150	180	200		
																							转速Speed r/min	
6IK120GU-AF□	6GU□K	50Hz	2.3	2.7	3.8	4.5	5.6	6.8	8.5	10.2	12.2	15.3	18.4	22.1	30.7	36.8	40	40	40	40	40	40	40	40
6IK120GU-CF□			23.4	27.5	38.7	45.9	57.1	69.3	86.7	104	124	156	187	225	313	375	400	400	400	400	400	400	400	400
6IK120GU-SF□			2.22	2.6	3.6	4.3	5.4	6.5	8.1	9.7	11.7	14.7	17.6	21.1	29.4	35.2	40	40	40	40	40	40	40	40
			2.4	26.5	36.7	43.8	55.0	66.3	87.6	98.8	119	149	179	215	300	359	400	400	400	400	400	400	400	400

容许力矩单位 Allowance Torque Unit: 上段 Upside (N.m) / 下段 Belowside (kgf.cm)

机型Type 电动机/减速器 Motor/Gearhead	减速比Gear Ratio	3	3.6	5	6	7.5	9	12.5	15	18	25	30	36	50	60	75	90	100	120	150	180	200		
																							转速Speed r/min	
6IK120GU-AF□	6GU□K	60Hz	1.8	2.2	3.0	3.6	4.6	5.5	6.8	8.2	9.8	12.4	14.9	17.8	24.8	29.7	37.1	40	40	40	40	40	40	40
6IK120GU-EF□			18.3	22.4	30.6	36.7	46.9	56.1	69.3	83.6	100	126	152	181	253	303	378	400	400	400	400	400	400	400
6IK120GU-HF□			1.8	2.2	3.0	3.5	4.4	5.3	6.7	8.0	9.6	12.0	14.5	17.3	24.1	28.9	36.1	40	40	40	40	40	40	40
6IK120GU-SF□			18.3	22.4	30.6	35.7	44.8	54.0	68.3	81.6	97.9	122	148	176	245	295	368	400	400	400	400	400	400	400

■ 容许悬挂负载·容许轴向负载 PERMISSIBLE OVERHUNG LOAD AND THRUST LOAD

电动机 (圆轴型) → P217页 Motor (Round Shaft) → P217
 减速器 → P217页 Gearhead → P217

■ 减速器的容许负载惯性惯量 J PERMISSIBLE LOAD INERTIA J FOR GEARHEAD

→ P218页 → P218

外形图 (单位 mm) DIMENSIONS(Unit mm)

减速器附有安装用螺丝

Mounting screws are included with gearhead.

● 导线型 Lead wiring Type ①

重量 Weight: 电动机 Motor 4.8kg 减速器 Gearhead 2.1kg

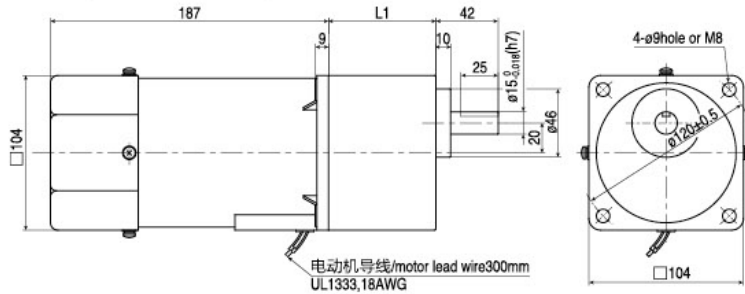

电动机导线/motor lead wire 300mm
UL1333, 18AWG

● 带端子箱型 Terminal Box Typ ②

重量 Weight: 电动机 Motor 4.95kg 减速器 Gearhead 2.1kg

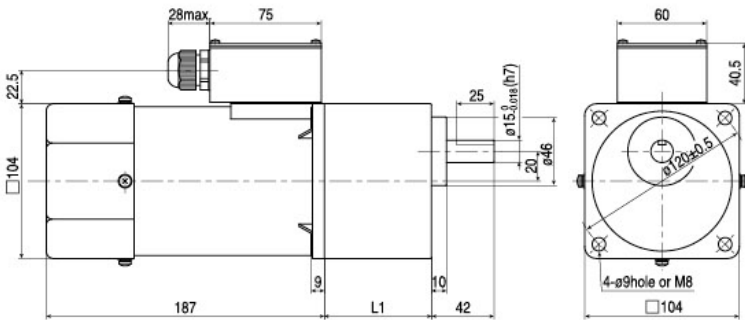

● 圆轴型的转轴部分 Shaft Section of Round Shaft Type

除重量及轴部外, 电动机外形与齿轮轴相同

Excluding weight and the shaft section Motor shape are the same as those of the pinion shaft type

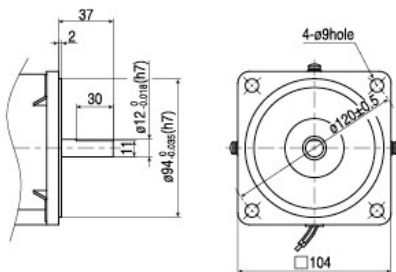

● 电容器外形尺寸 Formal Dimension of Capacitor

型号 Model		电容器型号 Capacitor Model	L	W	H
齿轮轴型 Pinion Shaft	圆轴型 Round Shaft				
6IK120GU-AF□	6IK120A-AF□	ZD300CFAUL	57	30	42
6IK120GU-EF□	6IK120A-EF□	ZD200CFAUL	47	23	35
6IK120GU-CF□	6IK120A-CF□	ZD80BFAUL	48	27	38

● 常规电容器出线为引线, 也可根据客户要求配置插片式187#

● 电动机型号的□中为表示带端子箱型的记号 (T)

● Note: Conventional capacitor is a lead wire type. Inserted 187# is optional

● Enter the code that represents the terminal box type (T) in the box (□) within the model name

电动机型号 Motor Model	减速器型号 Gearhead Model	减速比 Gear Ratio	L1
6IK120GU-AF 6IK120GU-EF 6IK120GU-CF 6IK120GU-HF 6IK120GU-SF	6GU□K	3~200	72

● 减速器型号的□中为减速比的数值

● Enter the gear ratio in the box (□) within the model name

电动机型号 Motor Model	减速器型号 Gearhead Model	减速比 Gear Ratio	L1
6IK120GU-AFT 6IK120GU-EFT 6IK120GU-CFT 6IK120GU-HFT 6IK120GU-SFT	6GU□K	3~200	72

● 减速器型号的□中为减速比的数值

● Enter the gear ratio in the box (□) within the model name

● 键·键槽 (减速器附件)

Key·keyway (The key is included with the gearhead)

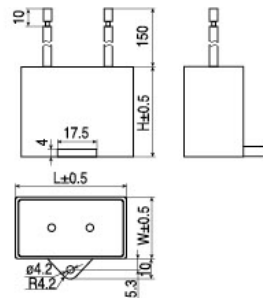
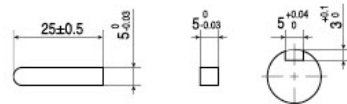

连接图 CONNECTION DIAGRAMS

- 运转方向指从电动机轴看来的方向。CW表示顺时针方向，CCW表示逆时针方向。
- 表中所记型号为齿轮轴型，圆轴型亦同。
- The direction of motor rotation is as viewed from the shaft end of motor.
CW represents the clockwise direction, while CCW represents the counterclockwise direction.
- Name indicated in the list is pinion shaft type, also valid for the equivalent round.

导线型 Lead Wire Type		带端子箱型 Terminal Box Type	
6IK120GU-AF、6IK120GU-EF 6IK120GU-CF、6IK120GU-HF	6IK120GU-SF	6IK120GU-AFT、6IK120GU-EFT 6IK120GU-CFT、6IK120GU-HFT	6IK120GU-SFT
<p>顺时针方向 CW</p> <p>电容器 Capacitance</p>	<p>顺时针方向 CW</p> <p>电容器 Capacitance</p>	<p>顺时针方向 CW</p> <p>电容器 Capacitance</p>	<p>顺时针方向 CW</p> <p>电容器 Capacitance</p>
<p>逆时针方向 CCW</p> <p>电容器 Capacitance</p>	<p>逆时针方向 CCW</p> <p>若对换R、S、T中任意二条， 电动机作逆时针方向动转 To change the rotation direction change any two connections between R.S and T.</p> <p>电容器 Capacitance</p>	<p>逆时针方向 CCW</p> <p>电容器 Capacitance</p>	<p>逆时针方向 CCW</p> <p>若对换R、S、T中任意二条， 电动机作逆时针方向动转 To change the rotation direction change any two connections between R.S and T.</p> <p>电容器 Capacitance</p>

● 请注意 Note:

- 单相电动机运转方向的转换应在电动机停止后进行。
- 若在电动机运转时转换运转方向，可能发生无法转换运转方向或须费时较久的情况。
- Change the direction of single-phase motor rotation only after bring the motor to a stop.
- If an attempt is made to change the direction of rotation while the motor is rotating, motor may ignore reversing command or change its direction of rotation after some delay.