

Ø 18mm Brushless

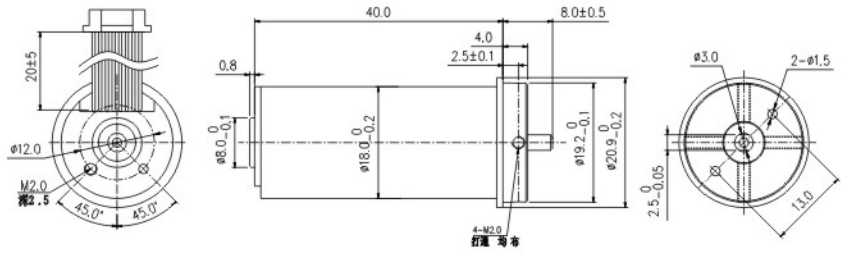

CB1844IH	UNIT	001	002	003	004
RATED VOLTAGE(额定电压)	V/DC	30			
RATED SPEED(额定转速)	RPM	13000			
NO LOAD SPEED(空载转速)	RPM	16000			
NO LOAD CURRENT(空载电流)	mA	120			
RATED CURRENT(额定电流)	mA	700			
RATED TORQUE(额定转矩)	mN.m	8			
RATED POWER(额定功率)	W	10.9			
MAX EFFICIENCY(最大效率)	%	62			
RESISTANCE PHASE TO PHASE	OHM	12			
TORQUE CONSTANT(转矩常数)	mN.m/A	17.9			
SPEED CONSTANT(速度常数)	rpm/V	533			
WEIGHT(重量)	g	60			

SPECIFICATION

AMBIENT TEMPERATURE RANGE	-20~55°C
MAX PERMISSIBLE WINDING TEMPERATURE	85°C
MAX PERMISSIBLE SPEED	30000rpm
MAX AXIAL LOAD	2.0N
MAX RADIAL LOADING	8.0N
NUMBER OF THE POLE PAIR	1
NUMBER OF THE PHASES	3

