

# ∅ 32mm Graphite Brushes

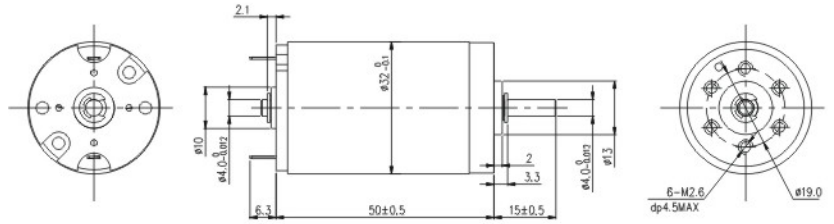

| CL3250                    | UNIT  | 001  | 002 | 003 | 004 |
|---------------------------|-------|------|-----|-----|-----|
| NOMINAL VOLTAGE(额定电压)     | V/DC  | 24   |     |     |     |
| NO LOAD SPEED(空载转速)       | rpm   | 6500 |     |     |     |
| RATED SPEED (额定转速)        | rpm   | 4700 |     |     |     |
| NO LOAD CURRENT(空载电流)     | mA    | 90   |     |     |     |
| RATED CURRENT(额定电流)       | mA    | 1200 |     |     |     |
| RATED TORQUE(额定转矩)        | mNm   | 39.2 |     |     |     |
| RATED POWER(额定功率)         | W     | 19.3 |     |     |     |
| STALL CURRENT(堵转电流)       | A     | 4.1  |     |     |     |
| STALL TORQUE(堵转转矩)        | mNm   | 146  |     |     |     |
| MAX. EFFICIENCY(最大效率)     | %     | 78   |     |     |     |
| TERMINAL RESISTANCE(端子电阻) | Ω     | 5.8  |     |     |     |
| TORQUE CONSTANT(转矩常数)     | mNm/A | 35.6 |     |     |     |
| SPEED CONSTANT(速度常数)      | rpm/V | 271  |     |     |     |
| WEIGHT(重量)                | g     | 200  |     |     |     |

## SPECIFICATION

|                                     |         |
|-------------------------------------|---------|
| AMBIENT TEMPERATURE RANGE           | -20~55℃ |
| MAX PERMISSIBLE WINDING TEMPERATURE | 125℃    |
| MAX PERMISSIBLE SPEED               | 8000rpm |
| MAX AXIAL LOAD                      | 4.0N    |
| MAX RADIAL LOADING                  | 20N     |
| NUMBER OF THE POLE PAIR             | 1       |
| NUMBER OF THE COMMUTATOR SEGMENTS   | 13      |

