

POWER OFF ACTIVATED TYPE ELECTROMAGNEIC BRAKE MOTORS 无励磁动作型电磁制动电动机

120W

□ 104mm



规格 / 电动机 SPECS / MOTOR

没有内藏简易制动 This type of motor does not contain a built-in simple brake mechanism.

品名 Model 机型 Type 导线型 Lead Wire Type		额定 Rating	输出功率 Output power W	电压 Voltage V	频率 Frequency Hz	电流 Current A	启动转矩 Starting Torque mN.m	额定转矩 Rated Torque mN.m	额定转速 Rated Speed r/min	电容器容量 Capacitor μ F
齿轮轴型 Pinion Shaft	圆轴型 Round Shaft									
6RK120GU-AM	6RK120A-AM	30min	120	1ph100	50	2.1	600	930	1200	35.0
					60					
6RK120GU-EM	6RK120A-EM	30min	120	1ph110 1ph120	60	1.70	600	750	1550	25
						1.80				
6RK120GU-CM	6RK120A-CM	30min	120	1ph220 1ph230	50	0.95	750	930	1250	8.0
6RK120GU-HM	6RK120A-HM	30min	120	1ph220 1ph230	60	0.95	700	750	1550	-
						1.0				
6RK120GU-SM	6RK120A-SM	30min	120	3ph220	50	0.75	2200	890	1250	-
					60					

● 各种安全规格以电动机铭牌上的型号取得认定。● ④:内藏热保护装置(自动复位型)。在电机因某种原因过热时会自行启动使电动机停止。● 电动机温度下降后恢复运行,故在进行检查作业时请务必事先切断电源。

● When the motor is approved under various safety standards, the model name on the nameplate is the approved model name. ● Contains a built-in thermal protector (automatic return). If a motor overheats for any reason, the thermal protctor is opened and the motor stops. ● When the motor temperature drops, the thermal protector closes and the motor restarts. Be sure to turn the motor off before inspecting.

种类 TYPE

● 电动机 MOTOR

机型 Type	型号 Model	
	齿轮轴型 Pinion Shaft	圆轴型 Round Shaft
导线型 Lead Wire Type	6RK120GU-AM	6RK120A-AM
	6RK120GU-EM	6RK120A-EM
	6RK120GU-CM	6RK120A-CM
	6RK120GU-HM	6RK120A-HM
	6RK120GU-SM	6RK120A-SM

● 平行轴减速器(另售) PARALLEL SHAFT GEARHEAD (SOLD SEPARATELY)

减速器种类 Gearhead Type	减速器型号 Gearhead Model	减速比 Gear Ratio
长寿命·低噪音 Long Life · Low Noise	6GU□K	3、3.6、5、6、7.5、9、12.5、15、18、25、30、36、50、60、75、90、100、120、150、180、200

● 减速器型号的□中为减速比的数值

● Enter the gear ratio in the box (□) within the model name

■ 装有减速器时的容许转矩

ALLOWABLE TORQUE WHEN BEING WITH GEARHEAD

- 减速器·中间减速器另售
- 减速器型号的□中为减速比的数值。
- □色表示与电动机同一方向运转，其他则为相反方向。
- 转速是以电动机的同步转速 (50Hz: 1500r/min、60Hz:1800r/min) 为基准除以减速比而算出来的数值。实际转速将随负载大小变化而比所示数值减少 2%~20%左右。
- Gearhead and mid-gearbox can be sold separately.
- Enter the gear ratio in the box (□) within the model name.
- The colored background □ indicates the same rotating direction of the motor while the rotating direction of others are opposite.
- The speed is calculated by dividing the motor's synchronous speed (50Hz: 1500r/min、60Hz: 1800r/min) by the gear ratio. The actual speed is 2%~20% less than the displayed value, depending on the size of the load.

容许力矩单位 Allowance Torque Unit: 上段 Upside (N.m) / 下段 Belowside (kgf.cm)

机型Type	减速比Gear Ratio	3	3.6	5	6	7.5	9	12.5	15	18	25	30	36	50	60	75	90	100	120	150	180	200			
电动机/减速器 Motor/Gearhead	转速Speed r/min	50Hz	500	417	300	250	200	166	120	100	83	60	50	41	30	25	20	16	15	12.5	10	8.3	7.5		
6RK120GU-AM	6GU□K	50Hz	2.3	2.7	3.8	4.5	5.6	6.8	8.5	10.2	12.2	15.3	18.4	22.1	30.7	36.8	40	40	40	40	40	40	40	40	
6RK120GU-CM			23.4	27.5	38.7	45.9	57.1	69.3	86.7	104	124	156	187	225	313	375	400	400	400	400	400	400	400	400	400
6RK120GU-SM			2.22	2.6	3.6	4.3	5.4	6.5	8.1	9.7	11.7	14.7	17.6	21.1	29.4	35.2	40	40	40	40	40	40	40	40	40
			24	26.5	36.7	43.8	55.0	66.3	87.6	98.8	119	149	179	215	300	359	400	400	400	400	400	400	400	400	400

容许力矩单位 Allowance Torque Unit: 上段 Upside (N.m) / 下段 Belowside (kgf.cm)

机型Type	减速比Gear Ratio	3	3.6	5	6	7.5	9	12.5	15	18	25	30	36	50	60	75	90	100	120	150	180	200			
电动机/减速器 Motor/Gearhead	转速Speed r/min	60Hz	600	500	360	300	240	200	144	120	100	72	60	50	36	30	24	20	18	15	12	10	9		
6RK120GU-AM	6GU□K	60Hz	1.8	2.2	3.0	3.6	4.6	5.5	6.8	8.2	9.8	12.4	14.9	17.8	24.8	29.7	37.1	40	40	40	40	40	40	40	
6RK120GU-EM			18.3	22.4	30.6	36.7	46.9	56.1	69.3	83.6	100	126	152	181	253	303	378	400	400	400	400	400	400	400	400
6RK120GU-HM			1.8	2.1	3.0	3.5	4.4	5.3	6.7	8.0	9.6	12.0	14.5	17.3	24.1	28.9	36.1	40	40	40	40	40	40	40	40
6RK120GU-SM			18.3	21.4	30.6	35.7	44.8	54.0	68.3	81.6	97.9	122	148	176	245	295	368	400	400	400	400	400	400	400	400

■ 容许悬挂负载·容许轴向负载

PERMISSIBLE OVERHUNG LOAD AND THRUST LOAD

电动机 (圆轴型) →P217 Motor (Round Shaft) →P217
 减速器 →P217 Gearhead →P217

■ 减速器的容许负载惯性惯量 J

PERMISSIBLE LOAD INERTIA J FOR GEARHEAD

→P218页 →P218

■ 起动、制动特性(参考值)

STARING AND BRAKE CHARACTERISTICS(REFERENCE VALUES)

● 单相电动机 Single-phase Motor

● 三相电动机 Three-phase Motor

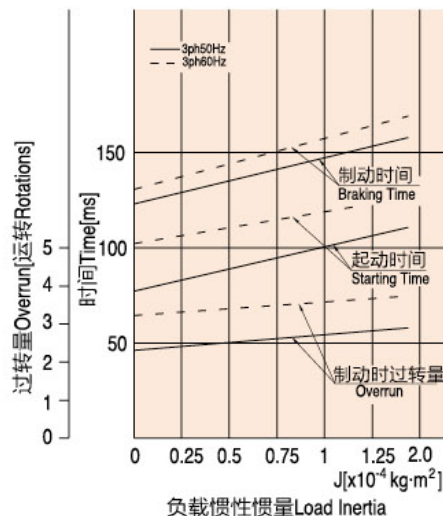
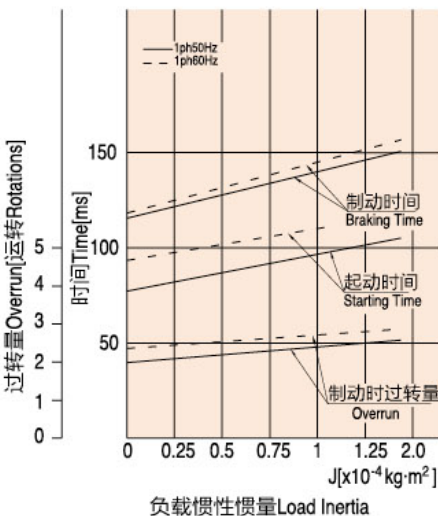

外形图 (单位 mm) DIMENSIONS(Unit mm)

减速器附有安装用螺丝
Mounting screws are included with gearhead.

● 导线型 Lead wiring Type

重量 Weight: 电动机 Motor 5.65kg 减速器 Gearhead 2.1kg

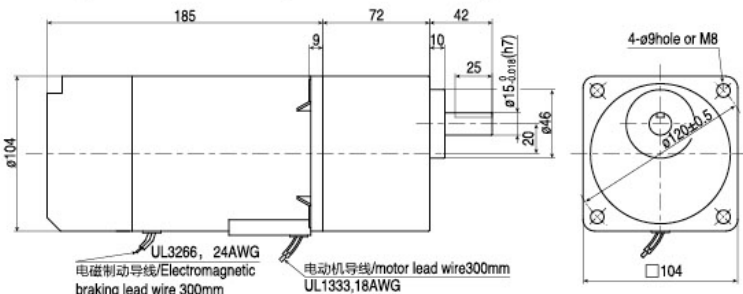

电动机型号 Motor Model	减速器型号 Gearhead Model	减速比 Gear Ratio	L1
6RK120GU-AM 6RK120GU-EM 6RK120GU-CM 6RK120GU-HM 6RK120GU-SM	6GU□K	3~200	72

- 减速器型号的□中为减速比的数值
- Enter the gear ratio in the box (□) within the model name

● 圆轴型的转轴部分 Shaft Section of Round Shaft Type

除重量及轴部外, 电动机外形与齿轮轴相同
Excluding weight and the shaft section Motor shape are the same as those of the pinion shaft

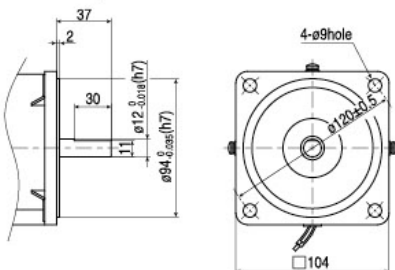

● 键·键槽 (减速器附件)

Key·keywa (The key is included with the gearhead)

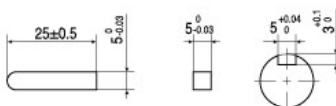

● 电容器外形尺寸 Formal Dimension of Capacitor

型号 Model		电容器型号 Capacitor Model	L	W	H
齿轮轴型 Pinion Shaft	圆轴型 Round Shaft				
6RK120GU-AM	6RK120A-AM	ZD350CFAUL	59	30	42
6RK120GU-EM	6RK120A-EM	ZD250CFAUL	59	30	42
6RK120GU-CM	6RK120A-CM	ZD80BFAUL	48	27	38

- 常规电容器出线为引线, 也可根据客户要求配置插片式187#
- Note: Conventional capacitor is a lead wire type. Inserted 187# is optional

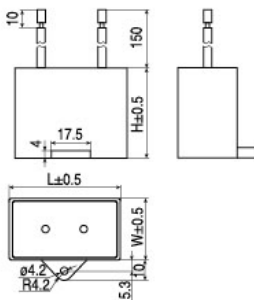

连接图 CONNECTION DIAGRAMS

- 运转方向指从电动机轴看来的方向。CW表示顺时针方向，CCW表示逆时针方向。
- 表中所记品名为齿轮轴型，圆轴型亦同。
- The direction of motor rotation is as viewed from the shaft end of motor.
CW represents the clockwise direction, while CCW represents the counterclockwise direction.
- Name indicated in the list is pinion shaft type, also valid for the equivalent round.

单相电动机 Single-phase Motor

6RK120GU-AM、6RK120GU-EM、6RK120GU-CM、6RK120GU-HM

- SW1为电动机的运行/停止及电磁制动操作开关。(联动) ● SW1设定ON时，电磁制动解除，电动机开始运作。
- SW1设定定期OFF时，电动机停止，电磁制动开始工作。
- 在电动机停止状态下解除电磁制动时，应将SW1设定为非联动，而仅将色导线侧的接触点设定ON。
- 运转方向 ● 将SW2转换至CW侧时，电动机作顺时针方向运转。 ● 将SW2转换至CCW侧时，电动机作逆时针方向运转。
- SW1 operates both motor and electromagnetic brake action. (Switched Simultaneously)
- The motor will rotate when SW1 is switched simultaneously to ON
- When SW1 is switched simultaneously to OFF, the motor is stopped, set the electromagnetic brake and holds the load.
- If you wish to release the brake while the motor is stopped, set the SW1 to be off and connection point at the side of black lead to be on.
- Direction of Rotation. ● To rotate the motor in a clockwise (CW) direction, turn SW2 to CW. ● To rotate the motor in a counterclockwise (CCW) direction, turn SW2 to CCW.

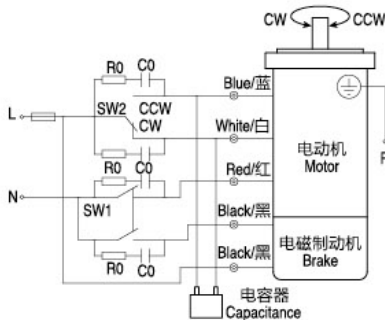

开关号码 Switch NO.	开关的接触点容量Contact capacity switch		参考 Note
	单相100V、110/120V输入 Single-Phase 100VAC, 110/120VAC Input	单相220V、230V输入 Single-Phase 200VAC, 220/230VAC Input	
SW1	AC125V 8A以上 (感应负载) 125 VAC 8A minimum (Inductive Load)	AC250V 8A以上 (感应负载) 250 VAC 8A minimum (Inductive Load)	联动Switched Simultaneously
SW2			

三相电动机 Three-phase Motor

6RK120GU-SM

- SW1为电动机的运行/停止及电磁制动操作开关。(联动) ● SW1设定ON时，电磁制动解除，电动机开始运作。
- SW1设定定期OFF时，电动机停止，电磁制动开始工作。
- 在电动机停止状态下解除电磁制动时，应将SW1设定为非联动，而仅将色导线侧的接触点设定ON。
- 运转方向 ● 若对换R、S、T中任意二条，电动机逆时针方向运转
- SW1 operates both motor and electromagnetic brake action. (Switched Simultaneously)
- The motor will rotate when SW1 is switched simultaneously to ON
- When SW1 is switched simultaneously to OFF, the moto is stopped, set the electromagnetic brake and holds the load.
- If you wish to release the brake while the motor is stopped, set the SW1 to off and connection point at the side of black lead to on.
- Direction of Rotation. ● To change the rotation direction, change any two connections among R, S and T.

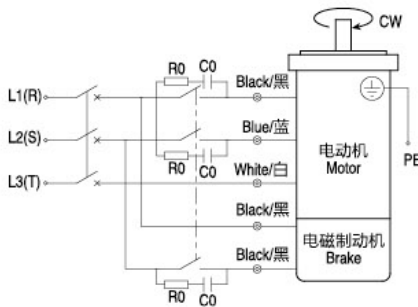

开关号码 Switch NO.	开关的接触点容量Contact capacity switch		参考 Note
SW1	AC250V 1.5A以上 (感应负载) AC250 VAC 1.5A minimum (Inductive Load)		联动Switched Simultaneously

● 请注意 Note:

- R0C0为吸收电涌电压用CR电路。[R0=5~200Ω C0=0.1~0.2μF、200WV(400WV)]
- 请使用选购配件EPCR1201-2
- R0 and C0 indicate surge suppressor circuit.[R0=5~200Ω C0=0.1~0.2μF、200WV(400WV)]
- EPCR1201-2 is available as an optional surge suppressor.